

자동화설비 부품전문 (주)영광테크

# Bolt / Nut / Washer

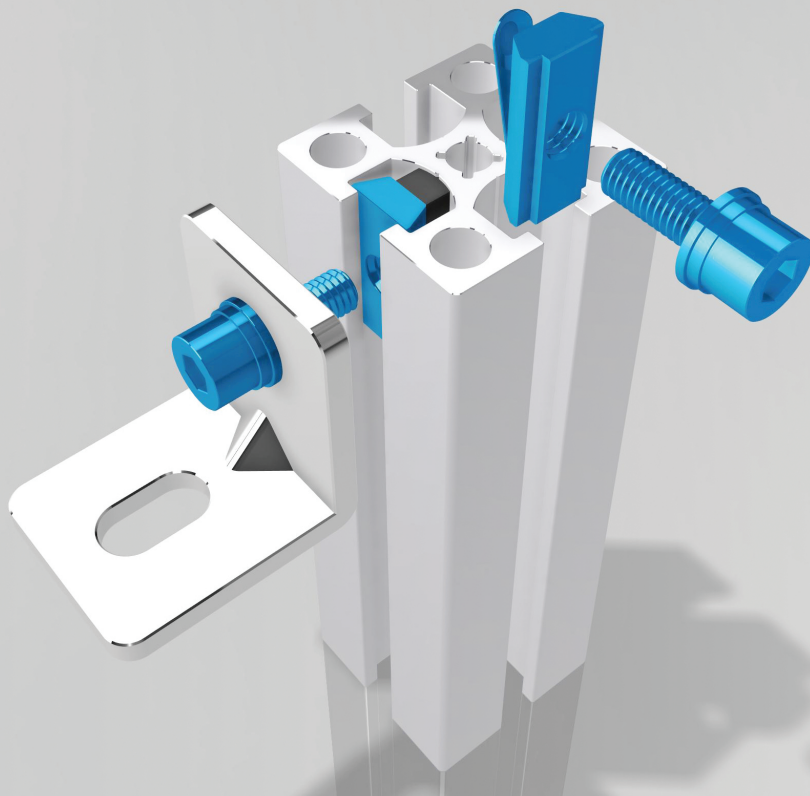

# Creating the Best Business Value

(주)영광테크는 품질과 환경, 고객을 생각하는 기업입니다.

## 13

# Bolt / Nut / Washer

메인화면 구성에 3D모델링은 실제품과 차이가 있을 수 있습니다.

### **볼트** \_page 358

- 등근머리렌지볼트 \_page 358
- T볼트 \_page 359
- 셈스볼트 \_page 360
- 육각렌지볼트 \_page 361
- 접시렌지볼트 \_page 362
- 무두렌지볼트 \_page 362
- 트러스십자볼트 \_page 362
- 육각볼트 \_page 363
- 아이볼트 \_page 363
- 노브볼트 \_page 363
- 사각볼트 \_page 364
- 근각볼트 \_page 364

### **너트** \_page 364

- 플랜지너트 \_page 364
- 스프링너트 \_page 365
- 스핀지너트 \_page 365
- 인서트너트 \_page 366
- T너트 \_page 368
- 볼너트 \_page 368
- 직사각너트 \_page 369
- 육각너트 \_page 369
- 정사각너트 \_page 370
- 캡너트 \_page 370
- Z너트 \_page 370
- 롱너트 \_page 371
- 탭플레이트 \_page 371

### **와셔** \_page 378

- 평와셔 KS 표준형 \_page 378
- 평와셔 특주형 \_page 378
- 평와셔 직사각형 \_page 378
- 스프링와셔 표준 \_page 379
- 스프링와셔 육각렌지볼트용 \_page 379
- 폴림방지와셔 \_page 379
- 네끼와셔 \_page 379



# BOLT / NUT / WASHER

인장 하중 시험인증서 / 다양한 종류의 제품군 보유 / 최고의 기술과 품질



프로파일 조립 시 가장 많이 사용되는 볼트와 너트 와서는 인장 하중 시험을 거쳐 공개하고 있으며 일반적인 볼트 외에 다양한 종류의 볼트를 제공할 수 있습니다.

조립 시 볼트가 너무 튀어 나오는걸 방지하는 볼트와 너트의 삽입이 없어도 조립 가능한 볼트, 무전해 니켈 도금부터 폴리싱, sus볼트까지 다양한 볼트들이 있습니다.

너트는 일반적인 너트부터 T볼트 체결용 너트, 볼트에 너트를 연결 후 프로파일 홈에 삽입하여 체결하는 방식, 너트를 프로파일 T홈에 삽입하여 체결하는 방식 등 다양한 사이즈와 종류들을 제공 하여 드릴 수 있습니다.

와서는 폴림방지용, 접시 렌지볼트 삽입용, 와셔 조인트클립형 까지 다양한 사이즈와 종류들을 제공하여 드릴 수 있습니다

## 둥근머리렌지볼트 YKB-WD



### Technical Data

Material	SCM435
Surface Processing	NI(니켈)
Application	프로파일 조립 및 브라켓 조립시 사용

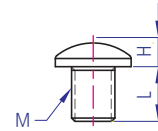
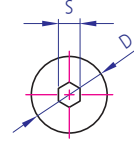

	M3	M4	M5(小,大)	M6	M8	M10	M12
D	5.5	7.5	9.5	10.5	14	18	21
H	1.7	2.2	2.8	3.3	4.4	5.5	6.6
S	2	2.5	3	4	5	6	6

## 둥근머리렌지볼트 YKB-WD SL(특주품)



### Technical Data

Material	SCM435
Surface Processing	NI(니켈)
Application	AL GUIDE 조립시 사용

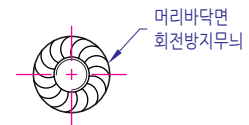
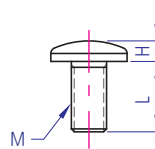
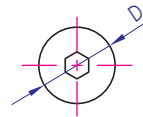

	M	L	H	D
YKB-WD SL5*10(Q11)	5	10	3.5	11
YKB-WD SL6*10(Q13)	6	10	3.5	13
YKB-WD SL6*12(Q13)	6	12	3.5	13

## 둥근머리렌지볼트 YKB-WD SH Series(특주품)



### Technical Data

Material	SCM435
Surface Processing	NI(니켈)
Application	프로파일 조립 및 브라켓 조립시 사용

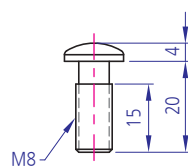
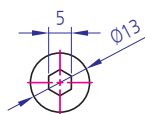

YKB-WD SH8\*20(5H)

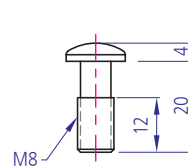
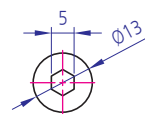

YKB-WD SH8\*20(8H)

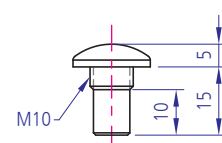
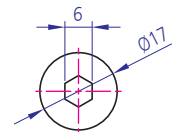

YKB-WD SH10\*15

### Technical Data

Material	SWCH10A, SUS304
Surface Processing	NI(니켈)
Application	조립시 볼트가 너무 튀어나오는것을 미려하게 조립
참고	기본품의 "L"값은 주문생산 가능

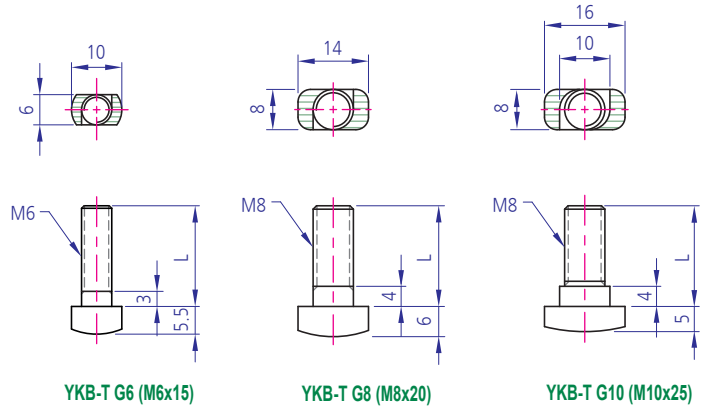

## T-BOLT(표준형) YKB-T G Series

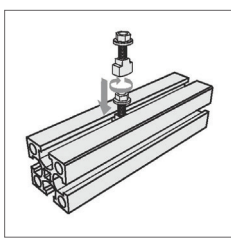

YKB-TG-6 Series  
YKB-TG-8 Series

M	L	H	h	B	W	Material	Plating
6	13,15,20,25~	5.5	3	6	10	SWCH10A (SUS)	NI
8	16,18,20,25,30~	6	4	8	14		

YKB-TG-10 Series

M	L	H	h	B	W	W1	Material	Plating
8	20,25,30,40	6	4	8	14	10	SWCH10A (SUS)	NI

### Technical Data

Material	SWCH10A
Surface Processing	NI(니켈)
Application	너트삽입의 번거로움없이 편리하게 조립가능
참고	기본품의 "L"값은 주문생산 가능

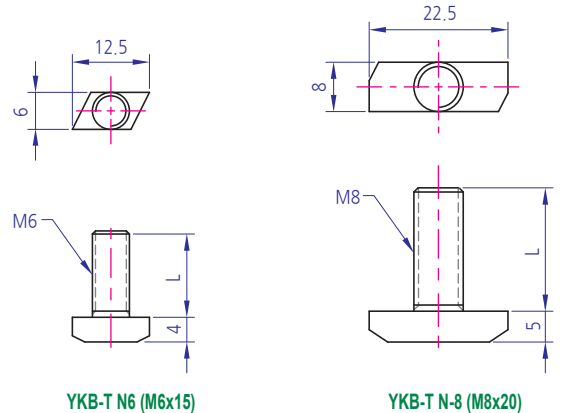

## T-BOLT(남선형) YKB-T N Series



YKB-T N-6 Series

M	L	H	B	W	Material	Plating
6	15	4	6	12.5	SWCH10A(SUS)	NI

YKB-T N-8 Series

M	L	H	B	W	Material	Plating
8	20,25,30,35,40	5	8	22.5	SWCH10A(SUS)	NI

### Technical Data

Material	SWCH10A
Surface Processing	NI(니켈)
Application	너트삽입의 번거로움없이 편리하게 조립가능

M	L	H	B	W
8	25,30,35	4	8	15

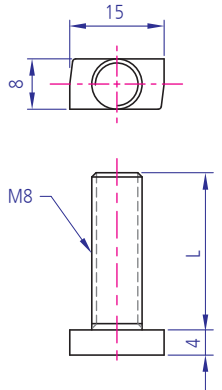

## T-BOLT(EV형) YKB-T EV Series



Roller  
Bearing  
Holder  
Motor  
Base  
Bracket  
Hanger  
Shaft  
Multi  
Block  
Joint  
Hinge  
Magnet  
Handle  
Foot  
Base  
Foot  
Levelling  
Foot  
Cover  
End Cap  
Bolt  
Nut  
Washer  
Special  
Profile  
Caster  
규격

Roller  
Bearing Holder  
Motor Base  
Bracket  
Hanger Shaft  
Multi Block  
Joint  
Hinge  
Magnet  
Handle  
Foot Base  
Levelling Foot  
Cover  
End Cap  
**Bolt**  
Nut  
Washer  
Special  
Profile  
Caster  
기형금

## T-BOLT(경남형) YKB-T K Series



M	L	H	B	W
6	15	4.5	6	10
8	16,20,25	6	8	14

### Technical Data

Material	SWCH10A
Surface Processing	NI(니켈)
Application	너트삽입의 번거로움없이 편리하게 조립가능

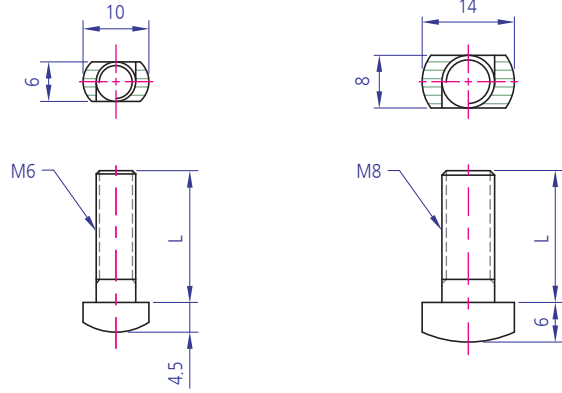

YKB-T K6

YKB-T K8

## T-BOLT(신성형) YKB-T S Series



### Technical Data

Material	SWCH10A
Surface Processing	NI(니켈)
Application	너트삽입의 번거로움없이 편리하게 조립가능

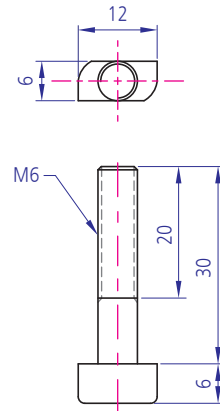

## 샘스렌지볼트 YKB-SW



M	L	H	D	D1	S
3	6~20	3	5.5	7	2.5
4	8~25	4	7	9	3
5	8~25	5	8.5	10	4
6	10~35	6	10	13	5
8	12~40	8	13	18	6
10	20~40	10	16	22	8

### Technical Data

Material	SCM435
Surface Processing	NI(니켈), ZN(아연), EL(무전해니켈)
Application	연결부품(평와셔, 스프링와셔 일체형)

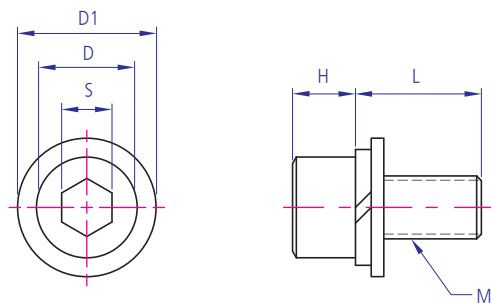

### Technical Data

Material	SCM435
Surface Processing	NI(니켈)
Application	연결부품(평와셔, 스프링와셔 일체형)

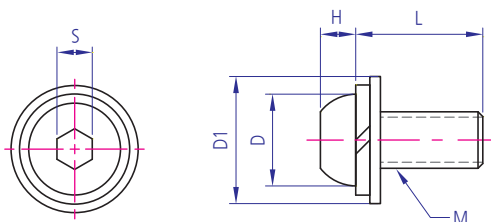

M	L	H	D	D1	S
5	10, 12, 15	3	8.5	10	3
6	12, 15, 20	4	10	13	4
8	15, 18, 20	5	13	18	5

## 셈스둥근렌지볼트 YKB-SD



### Technical Data

Material	S45C
Surface Processing	NI(니켈)
Application	연결부품(평와셔, 스프링와셔 일체형)

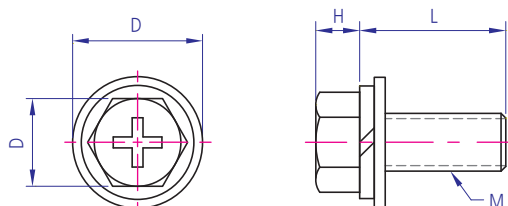

M	L	H	B	D
6	16	4.5	10	13
8	20, 22	6	12	18

## 셈스십자볼트 YKB-SC

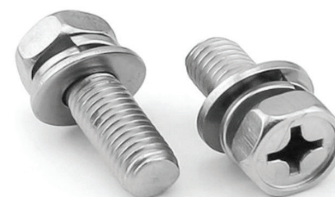

### Technical Data

Material	SCM435, SUS304
Surface Processing	NI(니켈), EL(무전해니켈)
Application	프로파일 조립 및 브라켓 조립시 사용

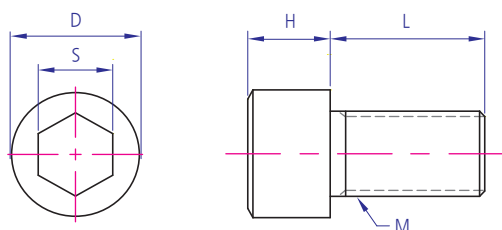

	M3	M4	M5	M6	M8	M10	M12	M16
L	6~20	6~25	6~25	8~35	10~40	12~40	15~160	20~200
H	3	4	5	6	8	10	12	16
D	5.5	7	8.5	10	13	16	18	24
S	2.5	3	4	5	6	8	10	14

## 육각렌지볼트 YKB-WO



Roller  
Bearing Holder  
Motor Base  
Bracket  
Hanger Shaft  
Multi Block  
Joint  
Hinge  
Magnet  
Handle  
Foot Base  
Levelling Foot  
Cover  
End Cap  
Bolt  
Nut  
Washer  
Special  
Profile  
Caster  
구멍

## 접시렌지볼트 YKB-WS



### Technical Data

Material	SCM435
Surface Processing	NI(니켈), EL(무전해니켈), SUS304
Application	프로파일 조립 및 브라켓 조립시 사용

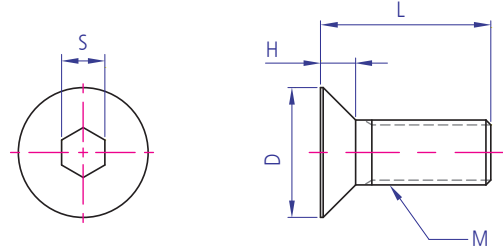

	M3	M4	M5	M6	M8	M10	M12
L	6~30	6~30	8~40	8~80	10~80	15~80	20~100
H	1.7	2.3	2.8	3.3	4.4	5.5	6.5
D	6	8	10	12	15	20	24
S	2	2.5	3	4	5	6	8

## 무두렌지볼트 YKB-WM



### Technical Data

Material	SCM435, SUS304
Surface Processing	NI(니켈), EL(무전해니켈)
Application	프로파일 조립 및 브라켓 조립시 사용
참고	플림방지 코팅가능

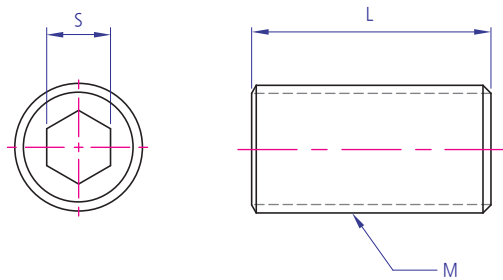

	M3	M4	M5	M6	M8	M10	M12	M16
L	3~30	4~50	5~45	5~50	5~80	6~80	12~80	16~80
S	1.5	2	2.5	3	4	5	6	8

## 트러스십자볼트 YKB-TR



### Technical Data

Material	SWCH10A, SUS304
Surface Processing	NI(니켈), PS(폴리싱)
Application	프로파일 조립 및 브라켓 조립시 사용

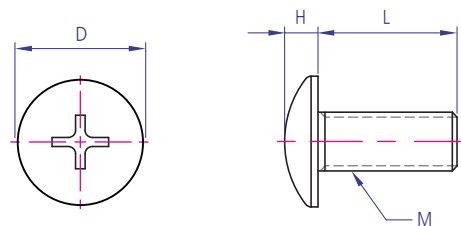

M	L	H	D
4	6, 8, 10, 12, 15	2.5	9.4
5	8, 10, 12, 15	3.1	11.8
6	8, 10, 12, 15, 16, 20	3.7	13.5
8	10, 12, 15, 18, 20, 25	4.8	17.8

Roller  
Bearing Holder  
Motor Base  
Bracket  
Hanger Shaft  
Multi Block  
Joint  
Hinge  
Magnet  
Handle  
Foot Base  
Leveling Foot  
Cover  
End Cap  
Bolt  
Nut  
Washer  
Special  
Profile  
Caster



### Technical Data

Material	SUS304, SCM435
Surface Processing	NI(니켈)
Application	프로파일 조립 및 브라켓 조립시 사용

M	L	H	B	C
6	8~150	4	10	11.5
8	10~160	5.5	13	15
10	15~160	7	17	19.6
12	20~200	8	19	21.9
16	25~200	10	24	27.7
20	35~200	13	30	34.6
24	45~200	15	36	41.6
30	50~200	19	46	53.1

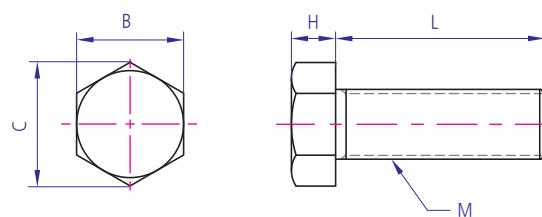

## 육각볼트 YKB-H

### Technical Data

Material	Stainless, SS
Surface Processing	전해연마, ZC
Application	분·배전반, 기타 산업기계

	M8	M10	M12	M16	M20	M24	M30
A	32.6	41	50	60	72	90	110
B	20	25	30	35	40	50	60
D	16	20	25	30	35	45	60
H	17	21	26	30	35	45	55
L	15	18	22	27	30	38	45

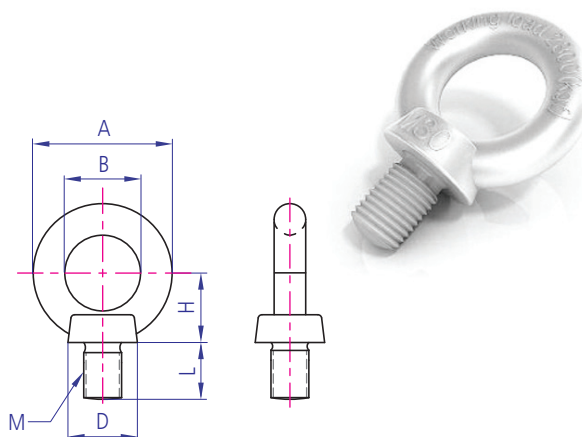

## 아이볼트 YKB-I

### Technical Data

Material	SUS304
Surface Processing	광택연마
Application	분·배전반, 기타 산업기계

제품명	M	D	H	L1	L2	d
CE-3006-L4	4	15	8	20, 25, 30	12	10
CE-3006-L5	5	15	8	20, 25, 30, 40	12	12
CE-3006-L6	6	18	10	30, 35, 40, 50	15	12
CE-3006-L8	8	24	10	40, 50	15	14
CE-3006-S4	4	15	8	10, 15	10	10
CE-3006-S5	5	15	8	10, 15	10	12
CE-3006-S6	6	18	10	10, 15	10	12

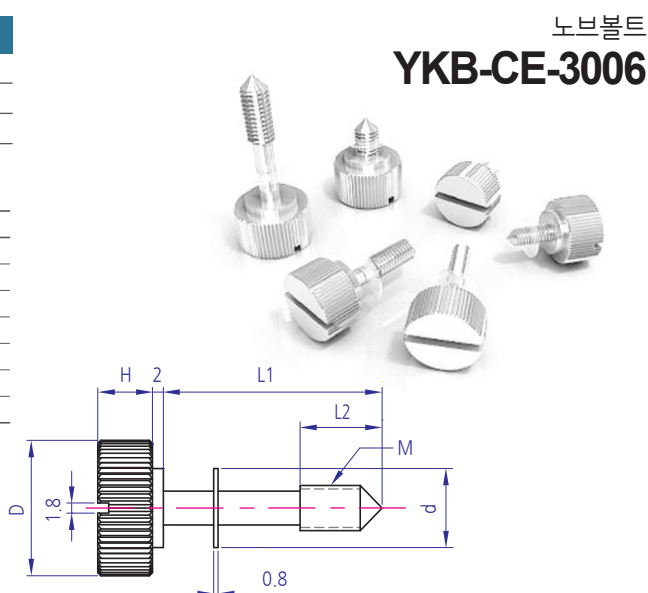

## 노브볼트 YKB-CE-3006

## 사각볼트

### YKB-SQ



M	D	H	B	Material	Plating
8	35, 40, 45	5.2	13	SCM435	Zn
10	40, 45, 50	7	18.5		

#### Technical Data

Material	SCM435
Surface Processing	ZN(백색)
Application	연결부품

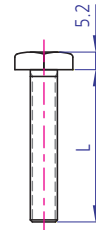
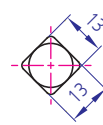

YKB-SQ 8xL

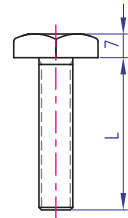
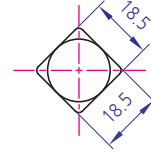

YKB-SQ 10xL

## 근각볼트

### YKB-G



M	L	H	h	D	B	Material	Plating
M8	30, 35	5	5	17.5	8	SCM435	Ni
3/8 inch	25, 38, 57	5	5	20.5	9.5		Zn(Wht)

#### Technical Data

Material	SCM435
Surface Processing	ZN(백색)
Application	연결부품

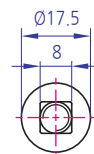
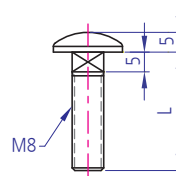

YKB-G 8xL

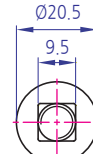
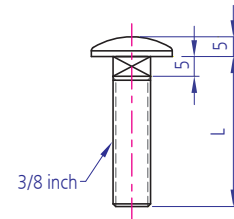

YKB-G 3/8xL

## FLANGE NUT

### YKN-F



#### Technical Data

Material	SWCH10A, SUS
Surface Processing	NI(니켈)
Application	T-Bolt 체결용 Nut

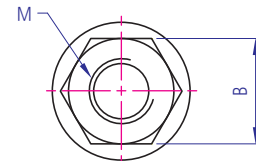
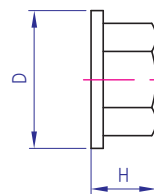

규격	D	H	B
M4	10	5	7
M5	11.5	5	8
M6	13.5	6	10
M8	17	8	12
M8×13	17	8	13
M8×14	18.5	8.5	14

### Technical Data

Material	SWRM8K
Surface Processing	NI(니켈), 주문사양(SUS, ZN)
Application	Frame 홈에 삽입후 스프링의 텐션으로 인하여 원하는 위치에 고정, 수직 방향으로 조립시 NUT의 흘러내림을 방지

## SPRING NUT (스프링너트-표준형) YKN-S G Series

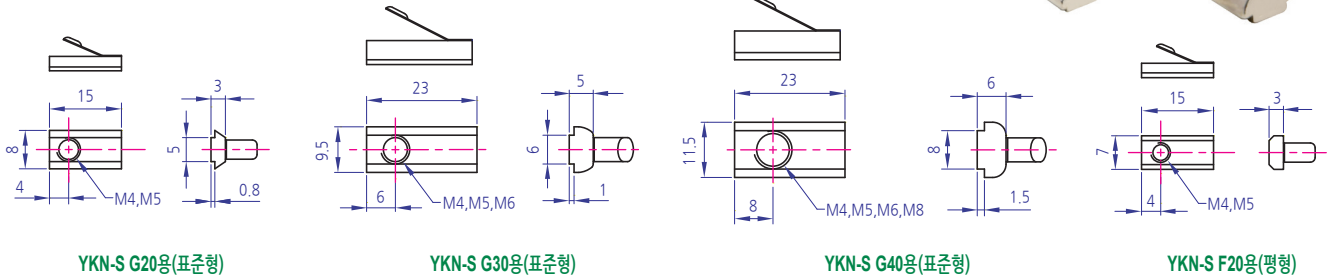

### Technical Data

Material	SWRM8K
Surface Processing	NI(니켈)
Application	Frame 홈에 삽입후 스펀지의 텐션으로 인하여 원하는 위치에 고정, 수직 방향으로 조립시 NUT의 흘러내림을 방지

## SPRING NUT(스프링너트-중심형) YKN-S C Series

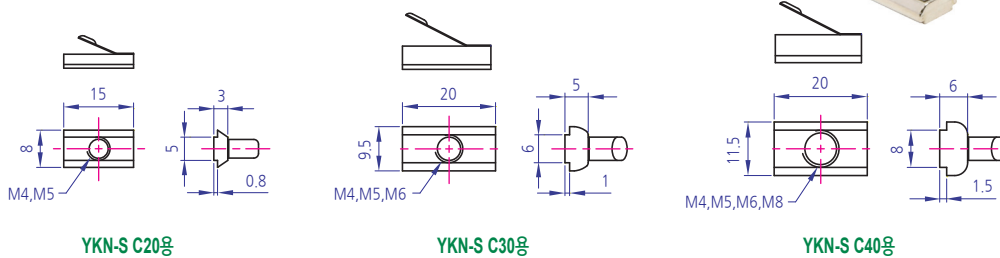

### Technical Data

Material	SWRM8K
Surface Processing	NI(니켈)
Application	Frame 홈에 삽입후 스펀지의 텐션으로 인하여 원하는 위치에 고정, 수직 방향으로 조립시 NUT의 흘러내림을 방지

## SPONGE NUT(스펀지너트-표준형) YKN-IS G Series

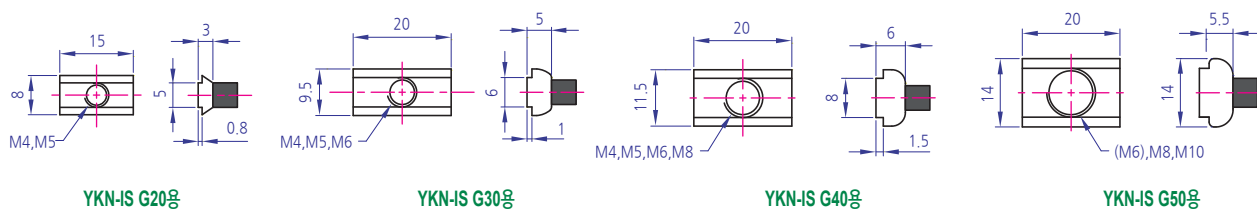

SPONGE NUT(스펀지너트-평형)

## YKN-IS F Series

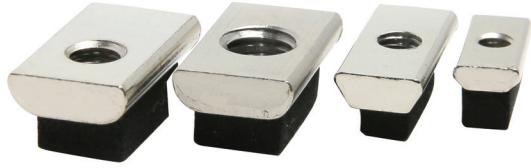

### Technical Data

Material	SWRM8K
Surface Processing	NI(니켈), ENI(주문사양)
Application	Frame 홈에 삽입후 스펀지의 텐션으로 인하여 원하는 위치에 고정, 수직 방향으로 조립시 NUT의 흘러내림을 방지

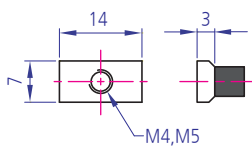

YKN-IS F20용

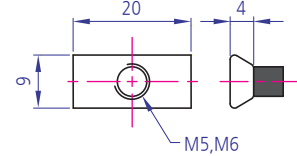

YKN-IS F30용

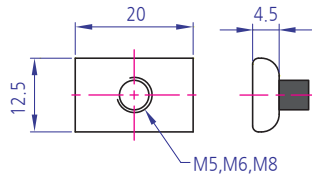

YKN-IS F40용

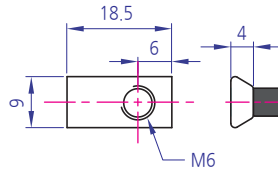

YKN-IS FS30용(편심)  
※주문사양

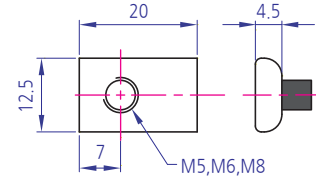

YKN-IS FS40용(편심)

INSERT NUT(인서트너트-표준형)

## YKN-I G Series

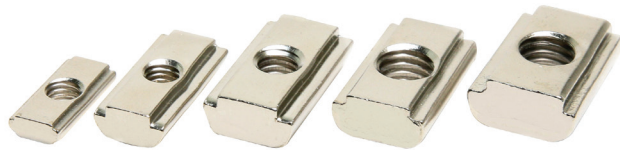

### Technical Data

Material	SWRM8K
Surface Processing	NI(니켈)
Application	프로파일 조립시 T홈 부위에 삽입하여 체결

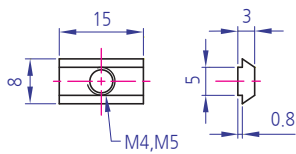

YKN-I G20용

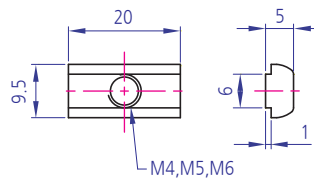

YKN-I G30용

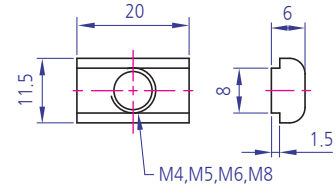

YKN-I G40용

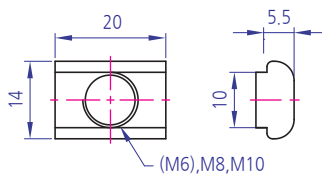

YKN-I G50용

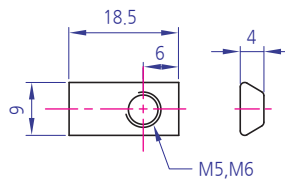

YKN-IS G30용  
※주문사양

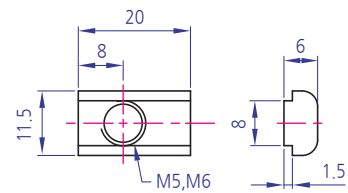

YKN-I GS40용(편심)

### Technical Data

Material	SWRM8K
Surface Processing	NI(니켈), ENI(주문사양)
Application	프로파일 조립시 T홈 부위에 삽입하여 체결

## INSERT NUT(인서트너트-평형) YKN-I F Series

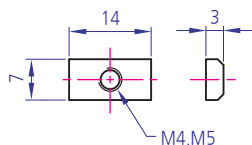

YKN-I F20용

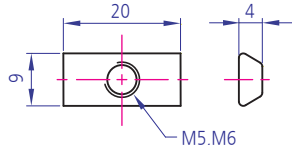

YKN-I F30용

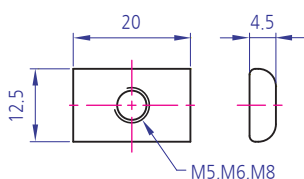

YKN-I F40용

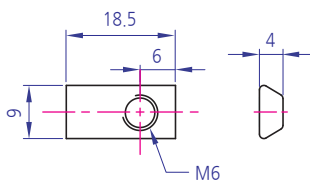

YKN-IS F30용(편심)  
\*주문사양

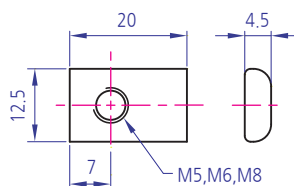

YKN-I FS40용(편심)

### Technical Data

Material	SWRM8K
Surface Processing	NI(니켈)
Application	프로파일 조립시 T홈 부위에 삽입하여 체결

## INSERT NUT(인서트너트-남선형) YKN-I N Series

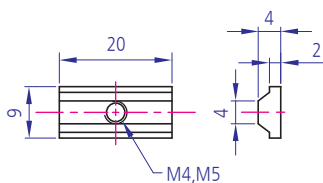

YKN-I N30-4T

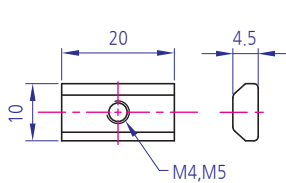

YKN-I N30-4.5T

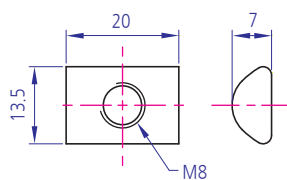

YKN-I N408

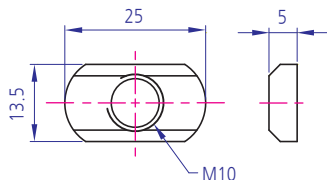

YKN-I N5010

T-NUT(표준형)

## YKN-T Series

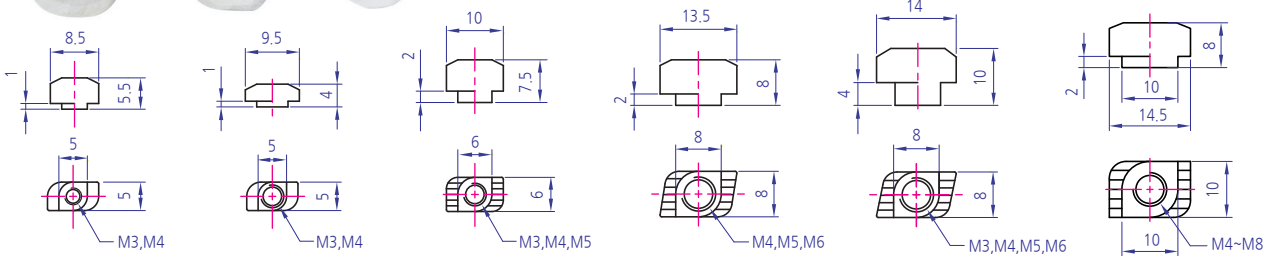

YKN-T M20용  
(대영,미래)

YKN-T G20용  
(남선 2035 Door용)

YKN-T G30용

YKN-T G308용

YKN-T G40용

YKN-T G50용

### Technical Data

Material	ZINC ALLOY
Surface Processing	NI(니켈)
Application	볼트에 직접 너트를 연결 후 프레임 홈에 너트를 삽입하여 체결하는 방식

T-NUT(스틸)

## YKN-T ST Series

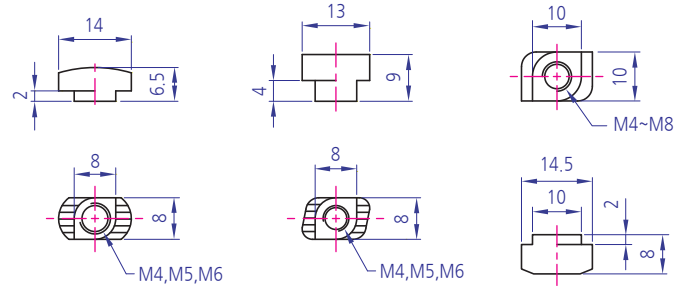

YKN-T ST308용

YKN-T ST40용

YKN-T ST50용

### Technical Data

Material	SWCH10A
Surface Processing	NI(니켈)
Application	볼트에 직접 너트를 연결 후 프레임 홈에 너트를 삽입하여 체결하는 방식

BALL NUT

## YKN-B

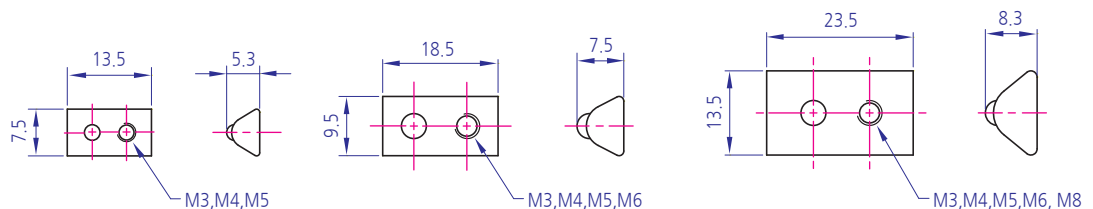

YKN-B20용

YKN-B30용

YKN-B40용

### Technical Data

Material	SWRM8K
Surface Processing	NI(니켈)
Application	Frame 홈에 삽입후 볼의 텐션으로 원하는 위치에 삽입하여 체결하는 방식
참고	발주예) 30 PROFILE용 M5 TAP : YKN-B 305, 주문제작 가능

### Technical Data

Material	SWCH10A
Surface Processing	NI(니켈), ZN(아연백색)
Application	선삽입형 체결 너트

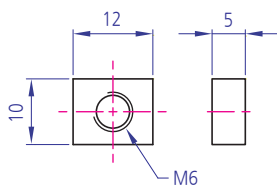

YKN-SR G306

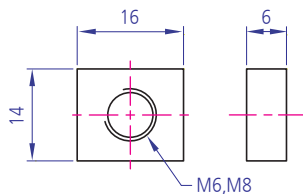

YKN-SR G406/G408

## 직사각너트(표준형) YKN-SR G Series



### Technical Data

Material	SWCH10A
Surface Processing	NI(니켈), ZN(백색)
Application	선삽입형 체결 너트

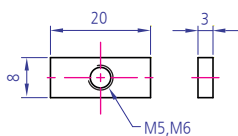

YKN-SR P8\*20-3T

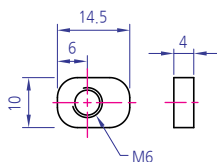

YKN-SR P10\*14.5-4T  
(분리형 멀티블럭용)

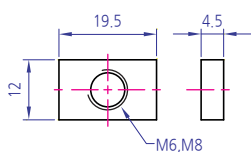

YKN-SR P12\*19.5-4.5T

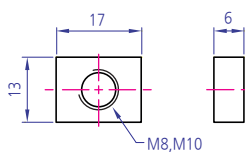

YKN-SR P13\*17-6T

## 직사각너트(P형) YKN-SR P Series



### Technical Data

Material	SWCH10A, SUS304, SCM435
Surface Processing	NI(니켈), Zn(백색)
Application	Bolt 고정

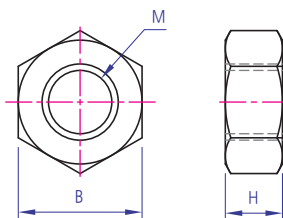

규격	H	B
M2	1.6	4
M3	2.4	5.5
M4	3.2	7
M5	4	8
M6	5	10
M8	6.5	13
M10	8	17
M12	10	19
M14	11	22
M16	13	24
M18	15	27
M20	16	30
M22	18	32
M24	19	36
M30	20	46

## 육각너트 YKN-H



정사각 너트

## YKN-SQ G, P Series



### Technical Data

Material	SWCH10A
Surface Processing	NI(니켈), ZN(백색), ZC(아연처리)
Application	선삽입형 체결너트

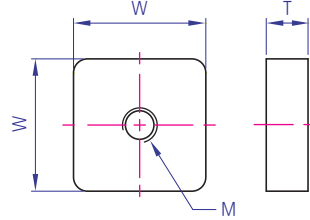

규격	W	T	M
YKN-SQ G4(분리 멀티블럭용)	7	2T	M4
YKN-SQ G20	8	2T/3T	M3(주문사항), M4, M5
YKN-SQ G30	10	5T	M5, M6
YKN-SQ G40	13.5	6T	M6, M8
YKN-SQ P13×13	13	6T	M8
YKN-SQ P19×19	19	6T	M5, M6

CAP NUT

## YKN-C Series

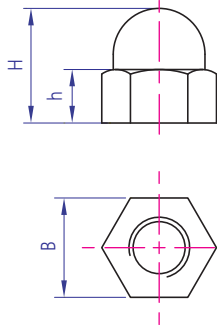

### Technical Data

Material	SS, SUS304
Surface Processing	NI(니켈)
Application	볼트 끝단부 마감처리

규격	D	B	H	h
YKN-C M3	3	5.5	6	3
YKN-C M4	4	7	8	4
YKN-C M5	5	8	10	4
YKN-C M6 - 12T	6	10	12	5
YKN-C M8 - 15T	8	13	15	7

Z-NUT

## YKN-Z Series

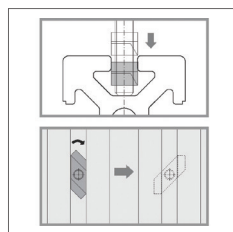

### Technical Data

Material	ZINC ALLOY
Surface Processing	NI(니켈)
Application	볼트에 직접 너트를 연결 후 프레임 홈에 너트를 삽입하여 바로 체결하는 방식

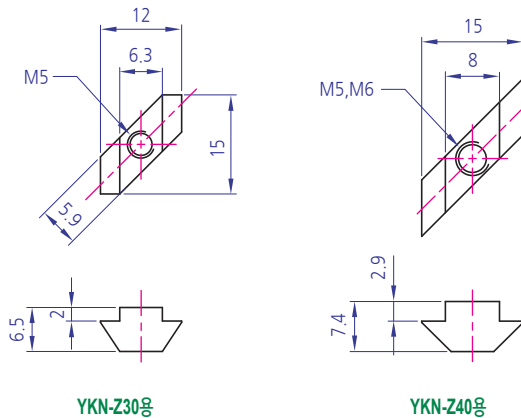



### Technical Data

Material	SPHC
Surface Processing	NI(니켈)
Application	프로파일 수평 연결시 가공없이 조립을 용이하게 함

## LONG NUT YKN-L

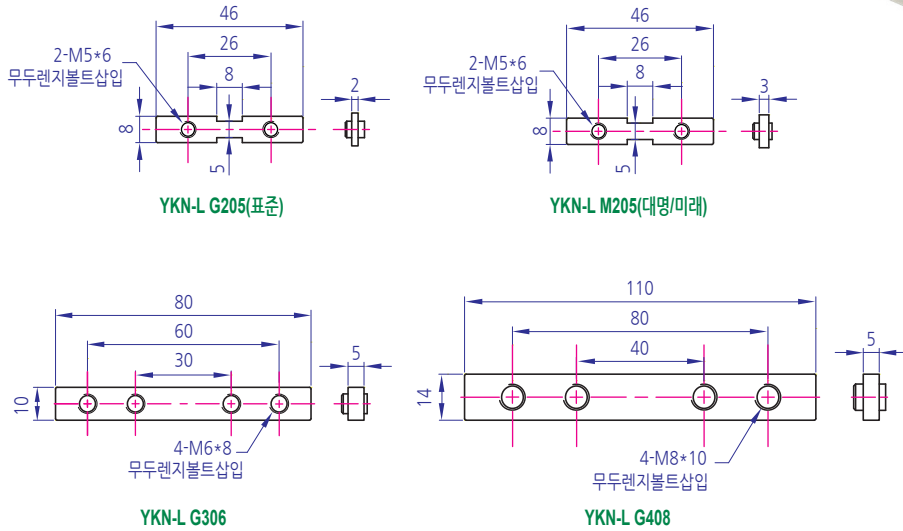

### Technical Data

Material	SWRM8K
Surface Processing	NI(니켈), ZN(아연), EL(무전해니켈)
Application	너트의 길이 및 TAP 위치 조정가능함.
참고	주문사양

## TAP PLATE YKN-TP IG Series

표준 인서트 너트

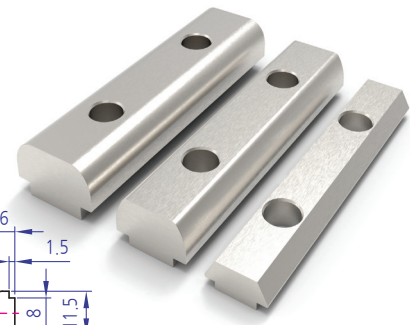
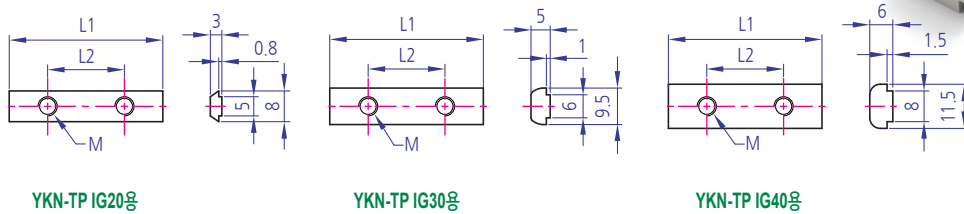

주문제작의 예

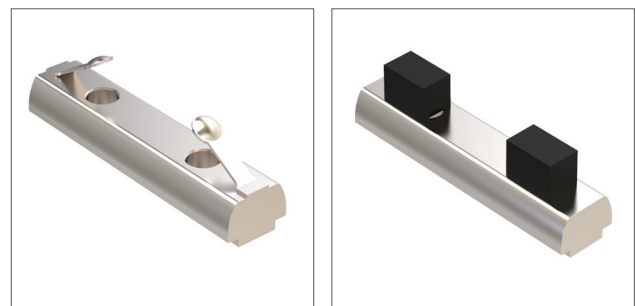
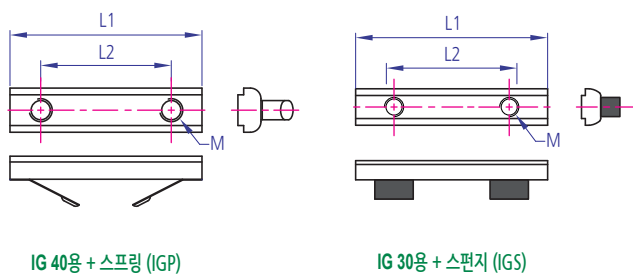

## TAP PLATE IF Series



### Technical Data

Material	SWRM8K
Surface Processing	NI(니켈), ZN(아연), EL(무전해니켈)
Application	주문사양
참고	너트의 길이 및 TAP 위치 조정가능함, SPONGE 부착가능



평 인서트 너트

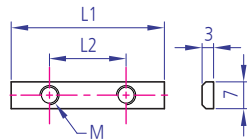

YKN-TP IF20용

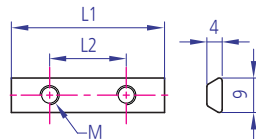

YKN-TP IF30용

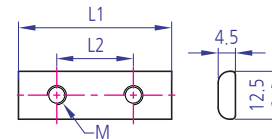

YKN-TP IF40용

주문제작의 예

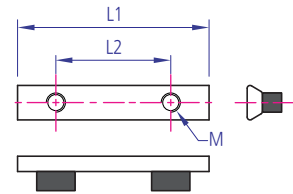

IF 30용 + 스펀지 (IFS)

## TAP PLATE SQ Series

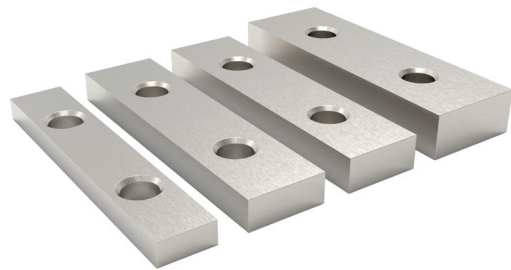

### Technical Data

Material	SWRM8K
Surface Processing	NI(니켈), ZN(아연), EL(무전해니켈)
Application	주문사양
참고	너트의 길이 및 TAP 위치 조정가능함, SPONGE 부착가능



주문제작의 예

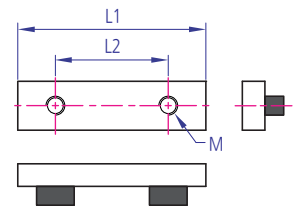

SQ 13용 + 스펀지

평 인서트 너트

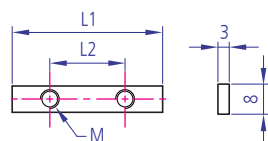

YKN-TP SQ8

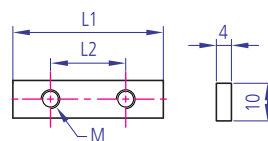

YKN-TP SQ10

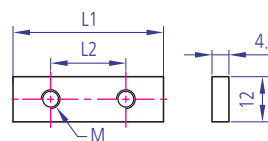

YKN-TP SQ12

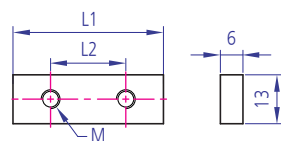

YKN-TP SQ13

### Technical Data

Material	STEEL
Surface Processing	ZN(아연도금)
Application	RAIL용 NUT
참고	너트의 길이 및 tap 위치 조정가능함. 주문제작 가능, 주문사양

## Key Nut (Rail용) YKN-TP Series

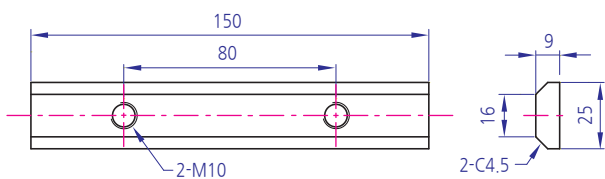
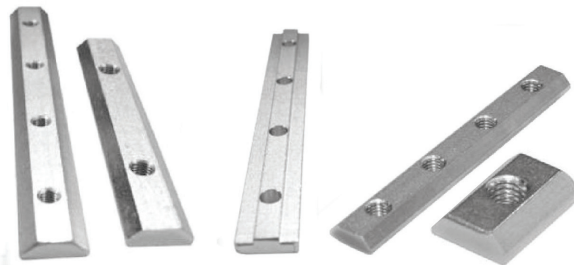

YKN-TP (2-M10, HP80) 25\*150-PT(ZN)

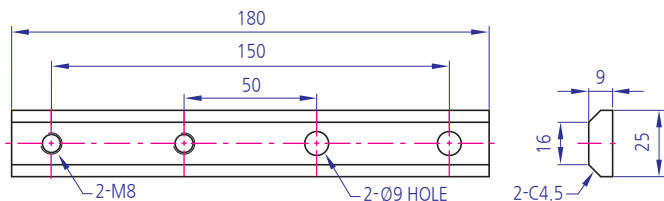

YKN-TP (2-M8, 2-Ø9, HP50) 25\*180-PT(ZN)

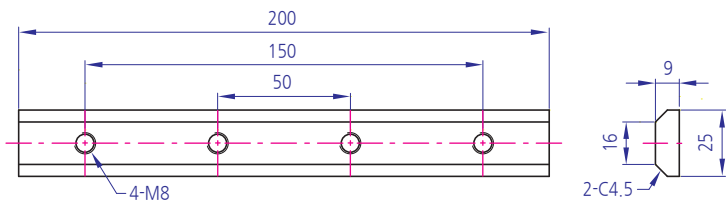

YKN-TP (4-M8, HP50) 25\*200-PT(ZN)

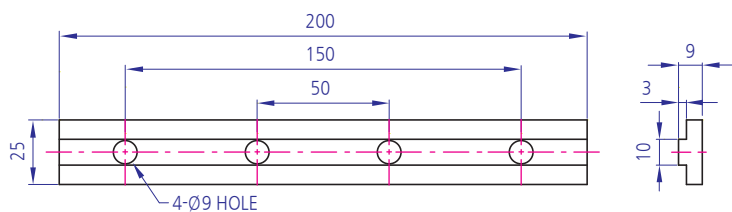

YKN-TP (4-Ø9, HP50) 25\*200-PT(ZN)

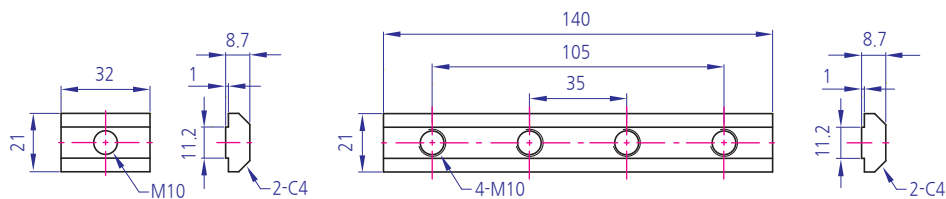

YKN-TP M10

YKN-TP(4-M10, HP35, 2-4C) 21\*140-8.7(ZN)

- Roller
- Bearing Holder
- Motor Base
- Bracket
- Hanger Shaft
- Multi Block
- Joint
- Hinge
- Magnet
- Handle
- Foot Base
- Levelling Foot
- Cover
- End Cap
- Bolt
- Nut**
- Washer
- Special
- Profile
- Caster
- 구멍

YKN-TP EVC SERIES

## YKN-TP EVC 18x9T

### Technical Data

Material	STEEL
Surface Processing	ZN(아연도금), ENI(무전해니켈), ZC(아연컬러)
Application	RAIL용 NUT, 주문사양

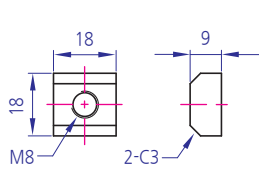

YKN-TP(M8, 2-C3) EVC18\*018\*9T

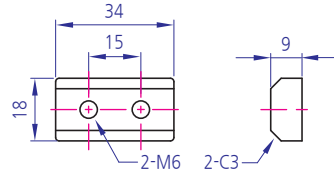

YKN-TP(2-M6, HP15, 2-C3) EVC18\*034\*9T

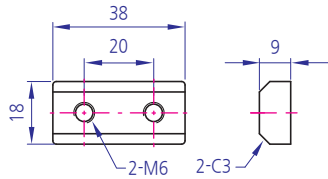

YKN-TP(2-M6, HP20, 2-C3) EVC18\*038\*9T

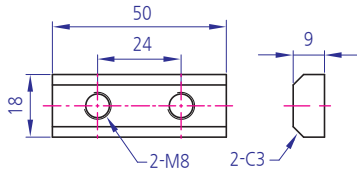

YKN-TP(2-M8, HP24) EVC18\*050\*9T

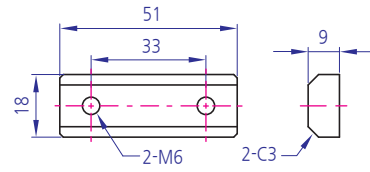

YKN-TP(2-M6, HP33, 2-C3) EVC18\*051\*9T

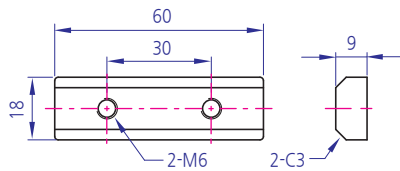

YKN-TP(2-M6, HP30, 2-C3) EVC18\*060\*9T

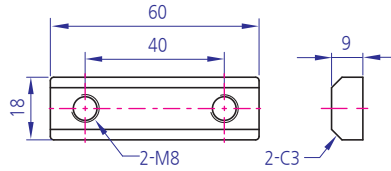

YKN-TP(2-M8, HP40, 2-C3) EVC18\*060\*9T

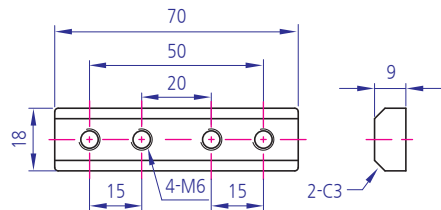

YKN-TP(4-M6, HP15-20-15, 2-C3) EVC18\*070\*9T

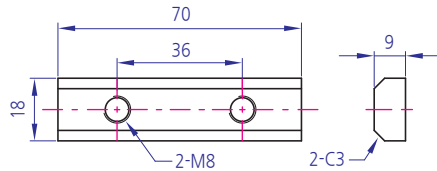

YKN-TP(2-M8, HP36, 2-C3) EVC18\*070\*9T

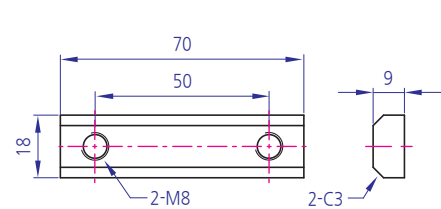

YKN-TP(2-M8, HP50, 2-C3) EVC18\*070\*9T

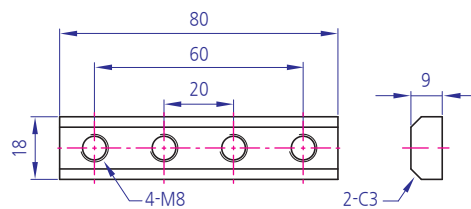

YKN-TP(4-M8, HP20, 2-C3) EVC18\*080\*9T

Technical Data

Material	STEEL
Surface Processing	ZN(아연도금), ENI(무전해니켈), ZC(아연칼러)
Application	RAIL용 NUT
참고	너트의 길이 및 tap 위치 조정가능함. 주문제작 가능, 주문사양

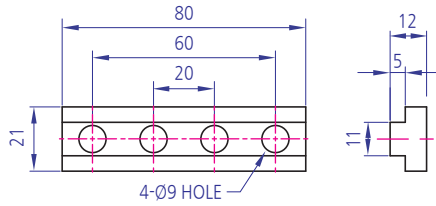

YKN-TP(4-Ø9, HP20) EVA 80\*21-12T

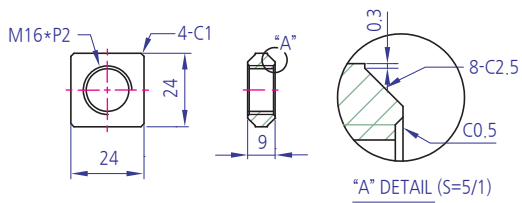

YKN-TP(M16, 8-C2.5, ST) EVC 24\*24-PT

TAP PLATE  
YKN-TP EV Series



Roller  
Bearing Holder  
Motor Base  
Bracket  
Hanger Shaft  
Multi Block  
Joint  
Hinge  
Magnet  
Handle

Technical Data

Material	STEEL
Surface Processing	ZN(아연도금), ENI(무전해니켈), ZC(아연칼러)
Application	RAIL용 NUT, 주문사양

TAP PLATE  
YKN-TP EV Series



EV TYPE

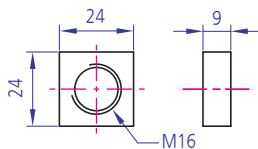

YKN-TP EV 24\*24 (M16)

EVC TYPE  
(모따기 처리)

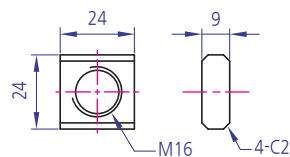

YKN-TP EVC 24\*24 (M16)

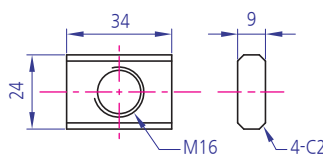

YKN-TP EVC 24\*34 (M16)

EV TYPE

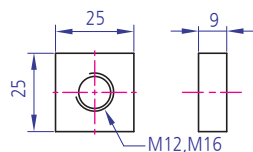

YKN-TP EV 25\*25 (M12, M16)

EVC TYPE  
(모따기 처리)

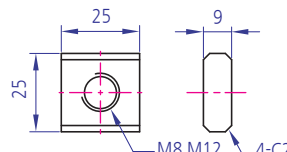

YKN-TP EVC 25\*25 (M8, M12)

Foot Base  
Levelling Foot  
Cover  
End Cap  
Bolt  
Nut  
Washer  
Special  
Profile  
Caster  
규형

TAP PLATE

## YKN-TP EV, EVA Series

### Technical Data

Material	STEEL
Surface Processing	ZN(아연도금), ZC, ENZ
Application	RAIL용 NUT, 주문사양

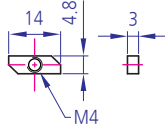

YKN-TP EV14\*4.8(M4)

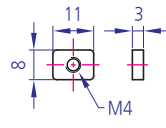

YKN-TP EV11\*8(M4)

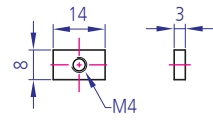

YKN-TP EV8\*14(M4)

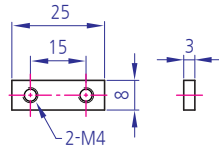

YKN-TP EV25\*8(M4)

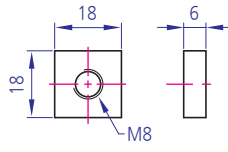

YKN-TP EV18\*18(M8)

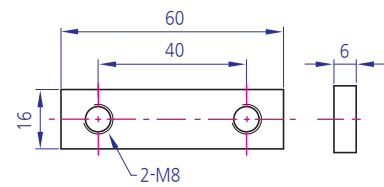

YKN-TP EV60\*16(2-M8)

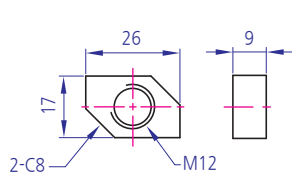

YKN-TP EV17\*26(M12)

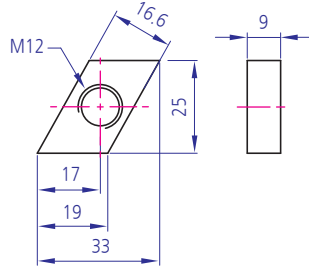

YKN-TP EV33\*25(M12)

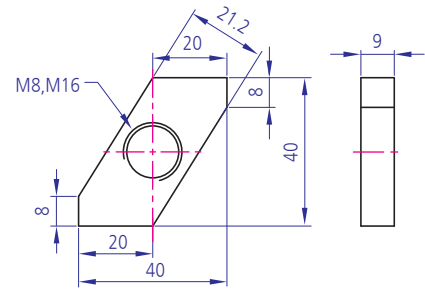

YKN-TP EV20\*40 (M8, M16)

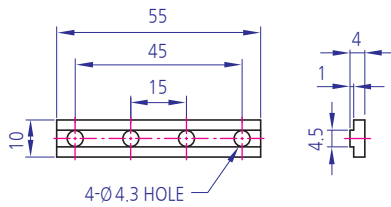

YKN-TP EV55\*10(4-Ø4.3)

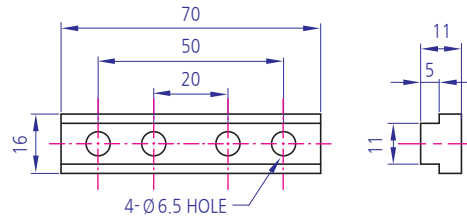

YKN-TP EV70\*16(4-Ø6.5)

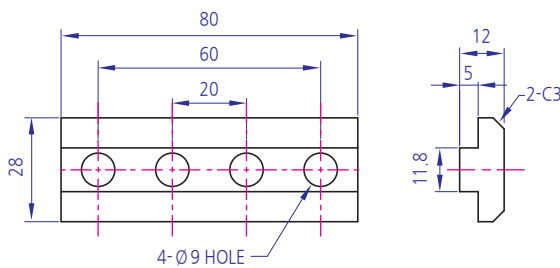

YKN-TP EV80\*28(4-Ø9)

Roller  
Bearing Holder  
Motor Base  
Bracket  
Hanger Shaft  
Multi Block  
Joint  
Hinge  
Magnet  
Handle  
Foot Base  
Levelling Foot  
Cover  
End Cap  
Bolt  
Nut  
Washer  
Special  
Profile  
Caster

### Technical Data

Material	SWRM8K
Surface Processing	NI(니켈), ZN(아연), EL(무전해니켈)
Application	작은너트를 프로파일홈에 삽입하여 작업할 때 체결에 어려움을 수월하게 해결가능
참고	너트의 길이 및 TAP 위치 조정가능함. 주문제작 가능

## TAP PLATE YKN-TP L Series(장너트)

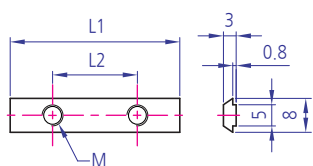

YKN-TP IG20

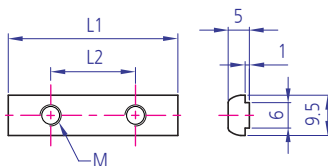

YKN-TP IG30용

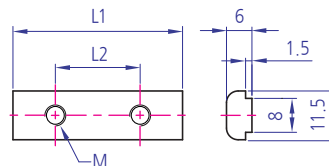

YKN-TP IG40용

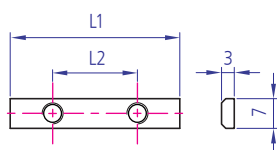

YKN-TP IF20용

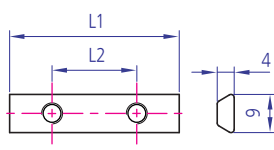

YKN-TP IF30용

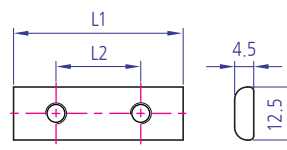

YKN-TP IF40용

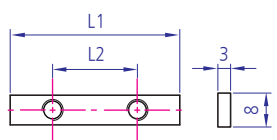

YKN-TP SQ8

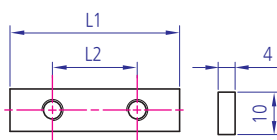

YKN-TP SQ10

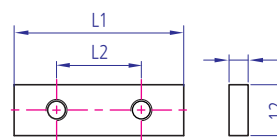

YKN-TP SQ12

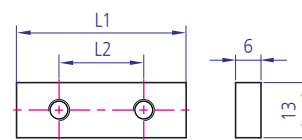

YKN-TPSQ13

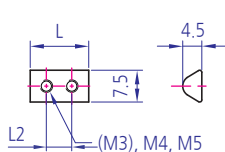

YKN-TP B 20용

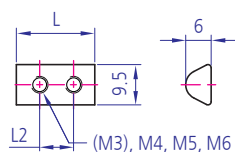

YKN-TP B 30용

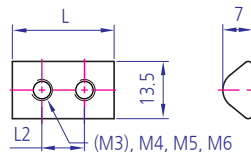

YKN-TP B 40용

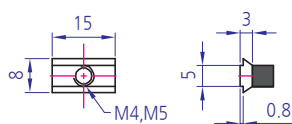

YKN-IS G20용

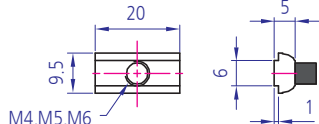

YKN-IS G30용

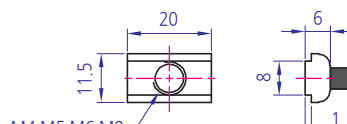

YKN-IS G40용

## 평와셔-KS표준형 YKW-P

### Technical Data

Material	SPCC, SPHC
Surface Processing	NI(니켈)
Application	

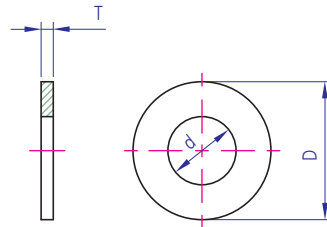

규격	d	D	T
M3	3.2	7	0.5
M4	4.3	9	0.8
M5	5.3	10	1
M6	6.4	12.5	1.6
M8	8.4	17	1.6
M10	10.5	21	2
M12	13	24	2.5
M16	17	30	3
M20	21	37	3
M24	25	44	4

## 평와셔-특주형 YKW-P

### Technical Data

Material	SPCC, SPHC
Surface Processing	NI(니켈)
Application	

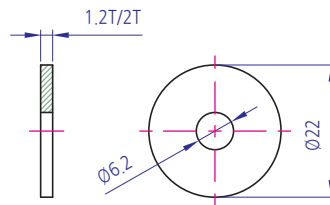

YKW-P 6\*22-1.2T/2T

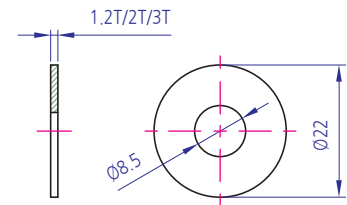

YKW-P 8\*22-1.2T/2T/3T

## 평와셔 직사각형 YKW-RP

### Technical Data

Material	SPCC
Surface Processing	NI(니켈)
Application	

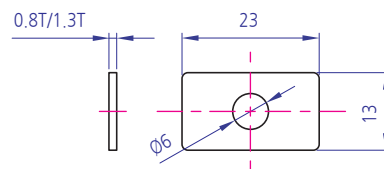

YKW-P R13x23-0.8T/1.3T

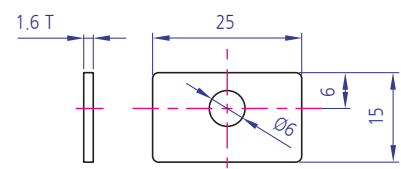

YKW-P R15x25-1.6T



### Technical Data

Material	SWRH
Surface Processing	NI(니켈)
Application	Bolt삽입으로 강한체결에 사용 (스프링 평와사만 삽입)

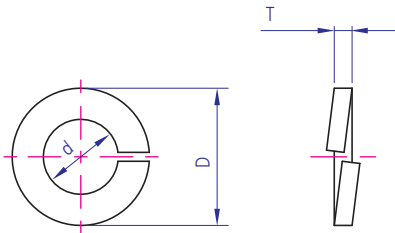

규격	d	D	T
M2	2.1	4.4	0.5
M3	3.1	5.9	0.7
M4	4.1	7.6	1.0
M5	5.4	9.2	1.3
M6	6.1	12.2	1.5
M8	8.2	15.4	2.0
M10	10.2	18.4	2.5
M12	12.2	21.5	3.0
M16	16.2	28.0	4.0
M20	20.2	33.8	5.1
M24	24.5	40.3	5.9
M30	30.5	49.9	7.5



### 스프링와셔-표준형 YKW-S G

### Technical Data

Material	SWRH
Surface Processing	NI(니켈)
Application	렌지볼트에 스프링와셔 체결시 외부간섭을 피하기 위해 사용됨

규격	d	D	T
M6	6.1	10	1.5
M8	8.1	13	2.0

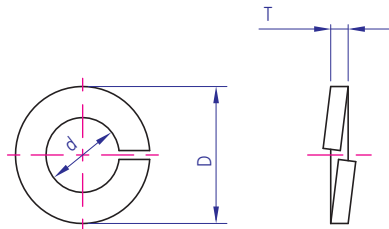

### 스프링와셔-육각렌지볼트용 YKW-S G

### Technical Data

Material	SUS, SK5
Surface Processing	AN
Application	폴림방지용

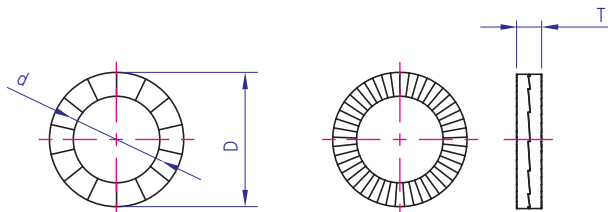

규격	d	D	T
M4	4.4	7.6	1.8
M5	5.4	9	1.8
M6	6.5	10.8	1.8
M8	8.7	13.5	2.5
M10	10.7	16.6	2.5
M12	13	19.5	2.5
M16	17	25.4	3.4
M20	21.4	30.7	3.4
M24	25.3	39	3.4
M30	31.4	47	6.6



### 폴림방지용 와셔 YKW-LK

네끄와셔  
**YKW-N**

### Technical Data

Material	STEEL
Surface Processing	NI(니켈)
Application	접시머리 렌지볼트 삽입용

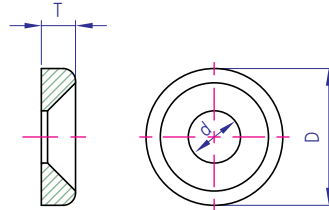

규격	d	D	T
M3	3.2	9	2.5
M4	4.2	11	3
M5	5.2	13	3.5
M6	6.2	16	3.7
M8	8.2	22	5.5
M10	10.2	28	6.5

Roller

Bearing Holder

Motor Base

Bracket

Hanger Shaft

Multi Block

Joint

Hinge

Magnet

Handle

Foot Base

Levelling Foot

Cover

End Cap

Bolt

Nut

**Washer**

Special

Profile

Caster

코형